

DIRECCION DE GESTION DE VIALIDAD
COORDINACION DE ESTUDIOS VIALES



PROYECTO: SERVICIO DE CONSULTORIA PARA EL MEJORAMIENTO DE LA CAPA DE RODADURA DE LA VIA C00COT0 - AMAGUASA

CONTIENE: VIA PLANTA PERFIL KM 01+000.00: 02+000.00

CONTRATO DE CONSULTORIA: LC-061-000-F-13-R	FECHA: 02 DE 13
ESCALAS: H 1:1000 Y L 1:100	BOLETA: 00180017
INGENIERO EN CARGO: ING. PABLO IRIGOYEN	REPRESENTANTE LEGAL: ING. MIGUEL DE LA TORRE

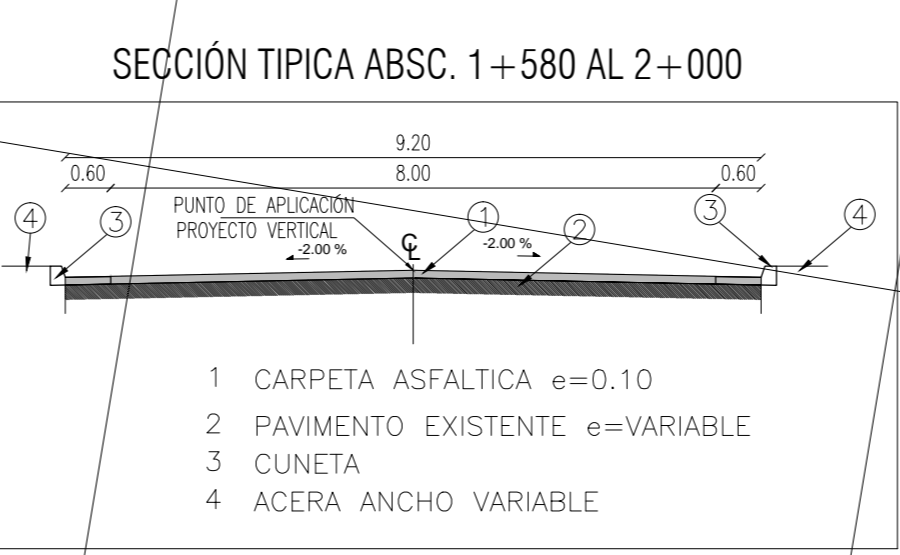
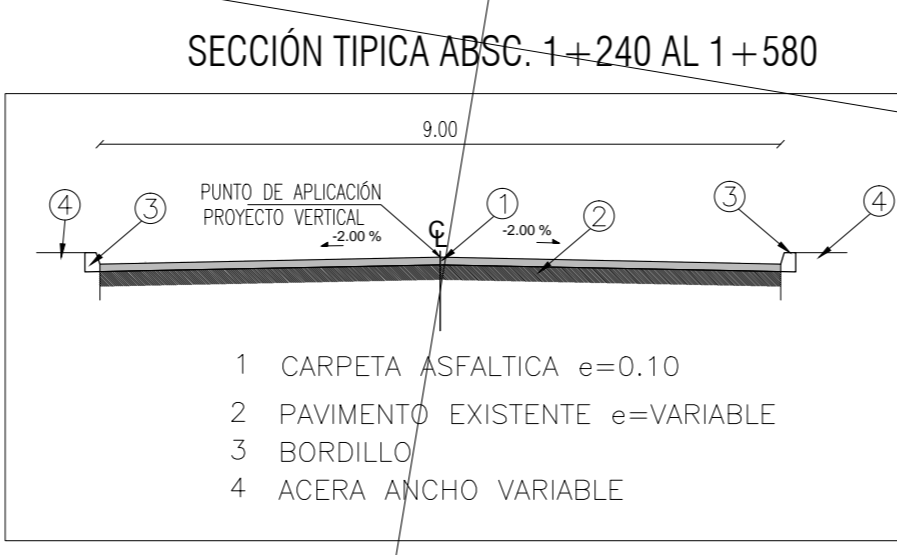

DESCRIPCION	SIMBOLO
POSTES DE LUZ	⊙
POZO	⊕
CENTRO DE COMUNICACION NACIONAL	⊙
HEMBRANTES	— —
POSTES DE SEMAFOROS	⊕
BORDILLO	— —
MURDO Y CERRAMIENTOS	⊕
CUNETAS	— —
REJILLA	⊕
SUMIDERO	⊕
CURVA DE NIVEL CADA 5 M	— —
CURVA DE NIVEL CADA 1 M	— —
FONDO DE RIO / QUERRADA	— —
ALCANTARILLA	⊕
CERRAMIENTO	— —

DESCRIPCION	NORTE	ESTE	COTA
REF3-01	9966693.864	779845.951	2557.104
REF3-02	9966680.893	779845.570	2557.156
REF4-01	9965970.394	779898.446	2542.400
REF4-02	9965958.028	779894.470	2542.697

No.	PI Station	Northing	Eastng	Distance	Direction
S1	1+003.58	9.966.790.04	779.837.08	28.17	S12° 52' 50.66"E
S2	1+055.75	9.966.790.04	779.837.08	52.44	S7° 58' 09.78"E
S3	1+104.19	9.966.710.13	779.850.76	120.73	S3° 15' 48.81"E
S4	1+224.82	9.966.589.57	779.857.64	100.39	S1° 29' 46.48"E
S5	1+325.31	9.966.489.21	779.860.08	270.31	S1° 50' 20.32"W
S6	1+400.62	9.966.210.03	779.851.12	61.99	S22° 48' 39.83"E
S7	1+466.61	9.966.152.06	779.875.50	73.80	S20° 37' 51.77"E
S8	1+740.42	9.966.086.07	779.908.59	111.04	S2° 05' 32.21"W
S9	1+851.45	9.965.974.03	779.904.50		

DATA	PI No.	DEFLEXION	RADIO	TANGENTE	EXTERNAL	LONGITUD	S (m)	α (°)
C6	14	004° 42' 20.97"	400.00	16.44	0.34	32.85	0.11	6.40
C7	15	001° 52' 02.33"	2000.00	32.59	0.27	65.18	0.21	4.1
C8	16	003° 14' 06.80"	1000.00	28.24	0.40	56.47	0.11	4.1
C9	17	012° 42' 48.31"	1200.00	13.37	0.74	26.63	0.57	5.30
C10	18	003° 49' 11.98"	800.00	20.01	0.33	40.00	0.62	4.1
C11	19	014° 43' 03.73"	90.00	11.62	0.75	23.12	0.24	4.10
C12	20	014° 00' 48.67"	700.00	8.60	0.53	17.12	0.75	6.40

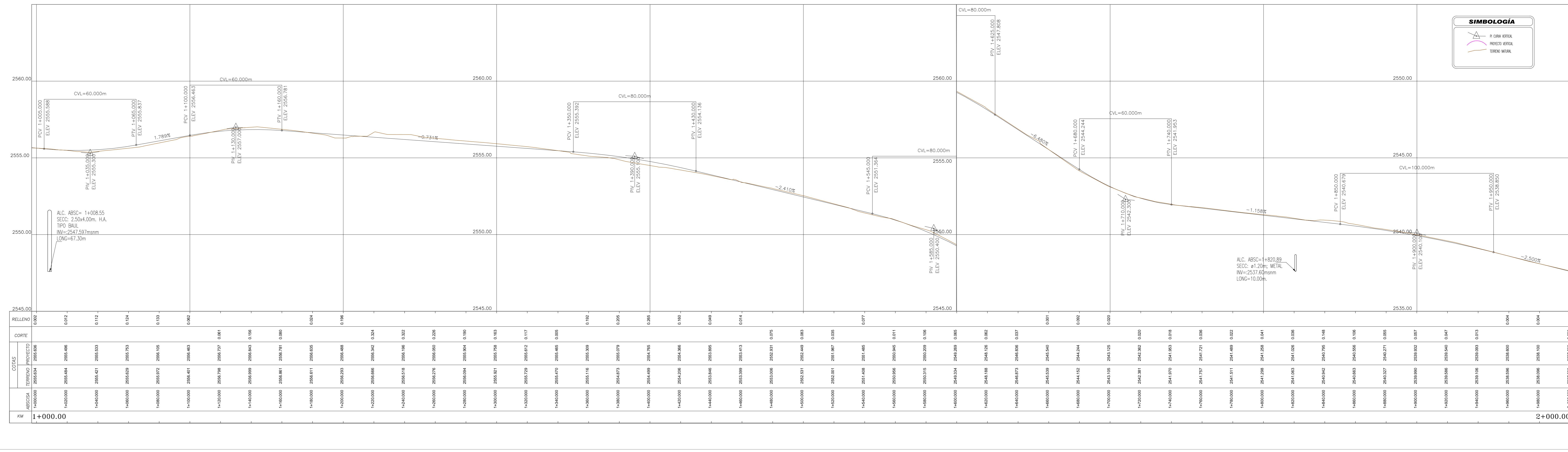
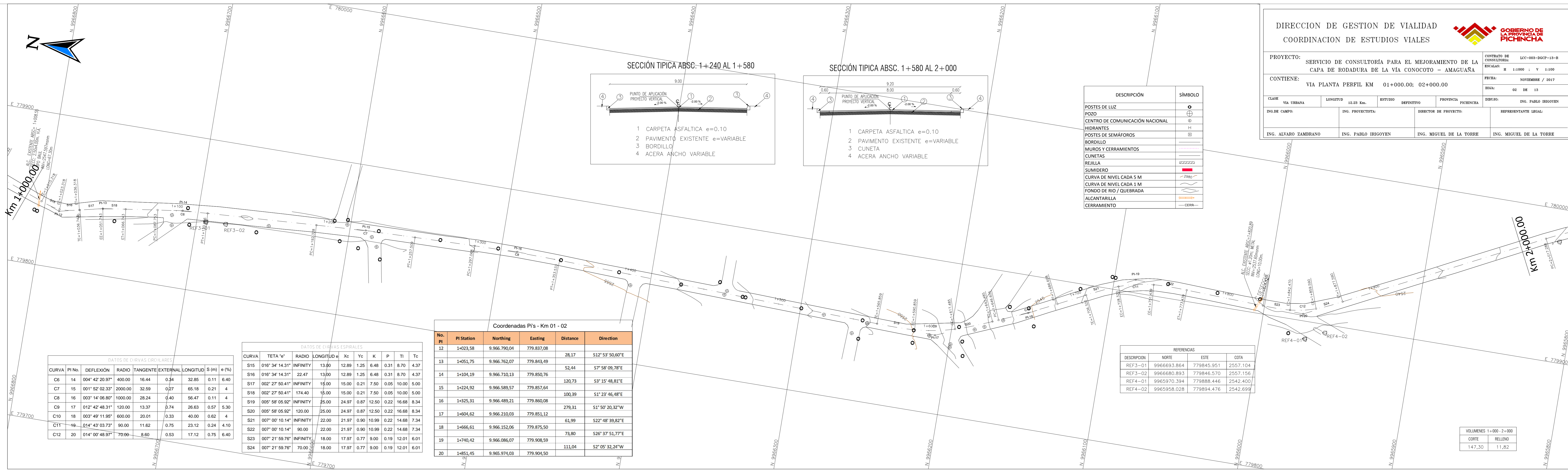

SIMBOLOGIA	
△	A DIM. ERG.
○	POZO ERG.
○	POZO MAN.
○	POZO MAN.